

MODELS LA AND LPA

LA: Vertical +180 Degree Turn

LPA: Vertical +180 Degree Turn + Side Pull

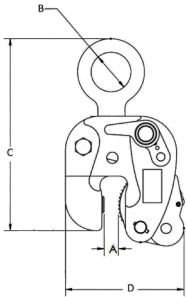

- Lightweight ergonomic design.
- Push button auxiliary lock allows 180 degree turn.
- Lock open / lock closed feature facilitates attachment to and removal from plate.
- LPA has pivoting lifting eye, allowing side loading.

Vertical Capacity (tons)	Part Number	Plate Thickness (in.) A	Lifting Eye (in.) B	Max Height (in.) C	Max Width (in.) D	Weight (lbs.)	Clamp Orientation
1/2	LA-00.50-A	0 - 5/8	1.13	8.69	4.25	5	Vertical + 180° turn
1	LA-01.00-A	0 - 3/4	1.13	8.69	4.38	6	Vertical + 180° turn
2	LA-02.00-A	0 - 1	2.38	12.50	7.06	17	Vertical + 180° turn
3	LA-03.00-A	0 - 1	3.38	17.00	8.50	32	Vertical + 180° turn
1/2	LPA-00.50-A	0 - 5/8	1.13	8.69	4.25	5	Vertical + 180° + side pull
1	LPA-01.00-A	0 - 3/4	1.13	8.69	4.38	6	Vertical + 180° + side pull
2	LPA-02.00-A	0 - 1	1.88	12.50	7.06	17	Vertical + 180° + side pull
3	LPA-03.00-A	0 - 1	3.63	17.00	8.50	32	Vertical + 180° + side pull

MODEL SCPA

Vertical + 180 Degree turn + Side Pull

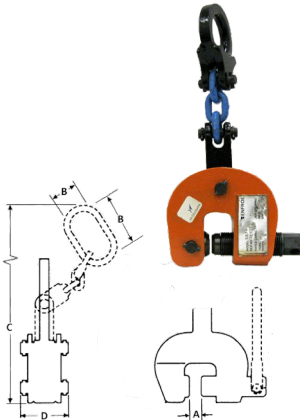

- Can be used in rolling and forming.
- Spring loaded cam.
- Can be used for horizontal lifts (use in pairs or sets of pairs).

Vertical Capacity (tons)	Part Number	Plate Thickness A	Lifting Eye B	Max Height C	Max Width D	Weight	Clamp Orientation
1/2	SCPA-00.50A	0 - 3/4	1.8 X 1.8	12.19	6.63	8	Vertical + 180° + side pull
1-1/2	SCPA-01.50A	0 - 1-1/4	2.0 X 2.0	14.19	8.44	15	Vertical + 180° + side pull
3	SCPA-03.00A	0 - 2	3.0X 6.0	21.38	10.19	24	Vertical + 180° + side pull
6	SCPA-06.00A	0 - 2-1/2	3.5 X 7.0	27.75	14.38	57	Vertical + 180° + side pull

MODEL FR

Vertical Only

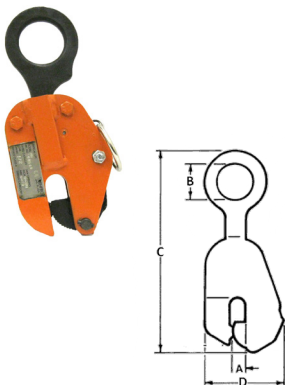

- Most popular clamp.
- Small and easy to handle.
- Serrated gripping cams.
- Lock closed feature.

Vertical Capacity (tons)	Part Number	Plate Thickness (in.) A	Lifting Eye (in.) B	Max Height (in.) C	Max Width (in.) D	Weight (lbs.)	Clamp Orientation
1/2	FR-00.50-A	0 - 3/4	2.38	11.25	4.63	8	Vertical only
1	FR-01.00-A	0 - 3/4	2.63	13.75	5.88	14	Vertical only
2	FR-02.00-A	0 - 1	3.63	16.38	6.75	23	Vertical only
3	FR-03.00-A	0 - 1-1/4	3.63	18.38	7.63	30	Vertical only

MODEL LHC



Horizontal

- Use in pairs, or tripod arrangement.
- Serrated gripping cams.
- Available with smooth non-marring cams.

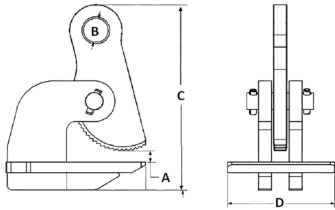

Vertical Capacity Each (tons)	Part Number	Plate Thickness A	Lifting Eye B	Body Height C	Max Width D	Weight	Clamp Orientation
1/4	LHC-00.2	0 – 1	1.00	5.38	2.25	3	Horizontal (use in pairs)
1/2	LHC-00.5	0 – 2	1.38	9.88	4.88	14	Horizontal (use in pairs)
3/4	LHC-00.7	0 – 2	1.41	10.00	5.38	19	Horizontal (use in pairs)
1-1/2	LHC-01.5	0 – 2	1.41	10.25	6.13	26	Horizontal (use in pairs)
3	LHC-03.0	0 – 2	1.41	10.88	6.13	24	Horizontal (use in pairs)
4	LHC-04.0	0 – 3	1.41	14.50	6.50	48	Horizontal (use in pairs)

MODELS J AND JP

J: Vertical + 90 Degree Turn

JP: Vertical + 90 Degree Turn + Side Pull



- Lock open / lock closed feature facilitates attachment to and removal from plate.
- JP has pivoting lifting eye, allowing side loading.
- Turn plate through 90 degree arc.

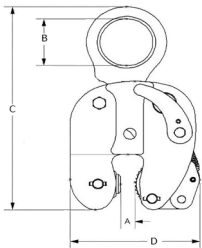

Vertical Capacity (tons)	Part Number	Plate Thickness (in.) A	Lifting Eye (in.) B	Max Height (in.) C	Max Width (in.) D	Weight (lbs.)	Clamp Orientation
1/2	J-00.50-A	0 – 5/8	2.38	12.00	5.63	10	Vertical + 90° turn
1	J-01.00-A	0 – 3/4	2.63	13.75	7.00	15	Vertical + 90° turn
2	J-02.00-A	0 – 1	3.50	17.38	8.75	36	Vertical + 90° turn
4	J-04.00-A	3/16 – 1-1/4	3.50	20.13	9.25	42	Vertical + 90° turn
1/2	JP-00.50-A	0 – 5/8	2.38	12.00	5.63	12	Vertical + 90° + side pull
1	JP-01.00-A	0 – 3/4	2.63	13.75	7.00	20	Vertical + 90° + side pull
2	JP-02.00-A	0 – 1	3.50	17.38	8.75	40	Vertical + 90° + side pull
4	JP-04.00-A	3/16 – 1-1/4	3.50	20.13	9.25	50	Vertical + 90° + side pull

MODEL 300-S DRUM LIFTER

Vertical only

- Secure locking device.
- Easy handling of one drum.
- Vertical lift and transport.

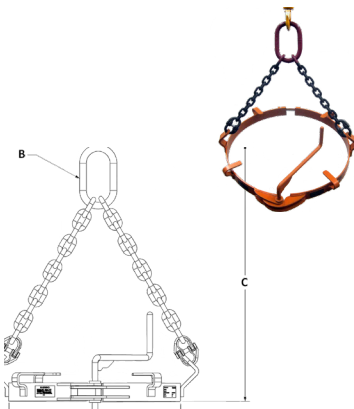

Vertical Capacity (tons)	Part Number	Drum Diameter	Lifting Eye B	Max Height C	Max Width D	Weight	Clamp Orientation
3000	300S-01.50-A	22.50	3 X 6	25	22.50	25	Vertical only