

CHAIN SLING HARDWARE

Eye Cradle Grab Hook – Code G

- For use with both G80 & G100 chain.
- Unique cradle grab design.
- Quenched and tempered alloy steel.
- 100% proof-tested.
- Fatigue rated.
- Durable powder-coated finish.
- Design factor 4:1.

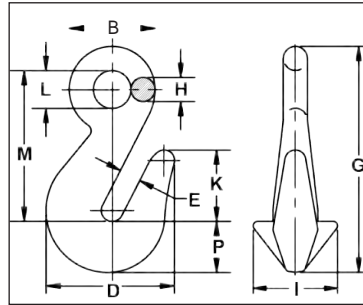

Grade	Chain Size (in.)	1Rated Cap.* (lbs.)	Part Number	Dimensions (in.)										Weight Each (lbs.)
				B	D	E	G	H	I	K	L	M	P	
100	7/32	2,700	732DECGH	1.20	1.68	.33	3.22	.33	.92	.99	.55	2.20	.69	0.35
100	9/32	4,300	932DECGH	1.40	1.93	.39	3.72	.39	1.07	1.07	.63	2.58	.76	0.55
100	3/8	8,800	38DECGH	1.78	2.86	.52	.481	.52	1.38	1.38	.75	3.27	1.02	1.39
100	1/2	15,000	12DECGH	2.28	3.69	.63	6.36	.63	1.81	1.81	1.06	4.23	1.53	3.05
100	5/8	22,600	58DECGH	2.75	4.53	.75	7.62	.75	2.13	2.13	1.25	5.06	1.80	4.36
100	3/4	35,300	34DECGH	3.50	5.23	.91	9.54	1.00	2.88	2.88	1.52	6.70	1.85	9.0
80	7/8	34,200	78G8ECGH	3.75	5.69	1.00	9.63	1.00	3.00	3.75	1.75	6.50	2.12	10.4
80	1	47,700	1G8ECGH	4.31	7.00	1.19	12.44	1.22	3.88	4.31	1.88	8.09	3.12	20.9
80	1-1/4	72,300	114G8CGH~	5.38	8.50	1.50	15.56	1.56	2.50	5.50	2.25	10.5	3.50	40

Note: 1-1/4" is a Non-Cradle type. Also, Non-Cradle Grab Hooks are available for other sizes upon request.

Foundry Hook – Code F

- For use with both G80 & G100 chain.
- Throat opening to 6 inches.
- Quenched and tempered alloy steel.
- 100% proof-tested.
- Fatigue rated.
- Durable powder-coated finish.
- Design factor 4:1.

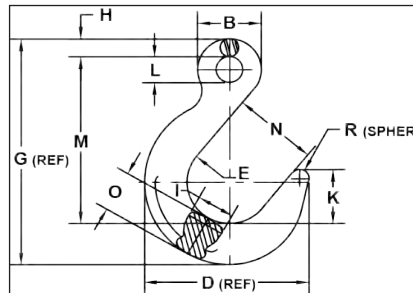

Grade	Chain Size (in.)	1Rated Cap.* (lbs.)	Part Number	Dimensions (in.)												Weight Each (lbs.)
				B	D	E	G	H	I	K	L	M	N	O	R	
100	9/32	4,300	932DEFH	1.56	4.73	2.50	6.45	.47	1.00	1.56	.63	4.75	2.50	1.23	.25	2.4
100	3/8	8,800	38DEFH	2.00	5.72	3.00	7.88	.63	1.27	1.88	.80	5.77	3.00	1.50	.31	4.5
100	1/2	15,000	12DEFH	2.50	6.74	3.50	9.38	.75	1.50	2.22	1.00	6.88	3.50	1.75	.38	7.1
100	5/8	22,600	58DEFH	3.00	7.79	4.00	10.97	.88	1.81	2.63	1.13	8.06	4.00	2.03	.44	11.6
100	3/4	35,300	34DEFH	3.50	9.07	4.50	12.81	1.00	2.20	3.00	1.50	9.25	4.50	2.56	.50	20
80	7/8	34,200	78G8EFH	4.00	10.09	5.00	14.23	1.13	2.25	3.38	1.70	10.38	5.00	2.78	.56	26
80	1	47,700	1G8EFH	4.50	11.55	5.50	16.17	1.29	2.63	3.75	2.13	11.56	5.50	3.45	.62	36.8
80	1-1/4	72,300	114G8EFH	5.13	12.87	6.00	18.03	1.38	3.17	4.25	2.33	12.88	6.00	3.81	.75	58.4

¹ Rated Capacity also referred to as Working Load Limit.

*** WARNING**

Do not exceed rated capacities. Sling capacity decreases as the angle from horizontal decreases. Do not use slings at angles of less than 30°. Refer to the Effect of Angle chart found in the General Information section of this catalog.

CHAIN SLING HARDWARE

Eye Latchlok Hooks – Code L

- Large eye design for use with G80 and G100 chain.
- 100% proof-tested.
- Positive locking hook.
- Meets ASTM A952 standards.
- Durable powder-coated finish.
- Design factor 4:1.

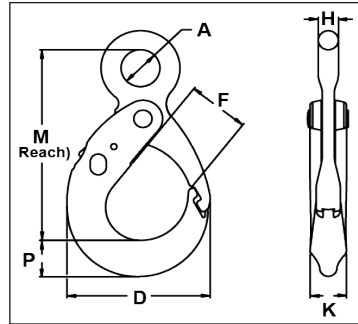

Chain Size (in.)	1Rated Capacity* (lbs.)	Part Number	Dimensions (in.)							Weight Each (lbs.)
			A	D	F	H	K	M	P	
9/32	4,300	932G10ELLH	1.09	3.77	1.64	0.47	0.91	5.37	0.88	2.50
3/8	8,800	38G10ELLH	1.36	4.74	2.27	0.59	1.15	6.65	1.07	4.74
1/2	15,000	12G10ELLH	1.57	6.26	2.91	0.80	1.47	8.79	1.58	10.00
5/8	22,600	58G10ELLH	2.0	7.37	3.22	1.03	1.85	10.37	1.97	16.00

Note: For welded 7/32" chain sling use 9/32" eye latchlok hook.

Chain Sling Eye Hook – Code S

- For use with both G80 and G100 chain.
- Quenched and tempered alloy steel.
- Fatigue rated.
- 100% proof-tested.
- Durable powder-coated finish.
- Design factor 4:1.
- Shown with optional latches.

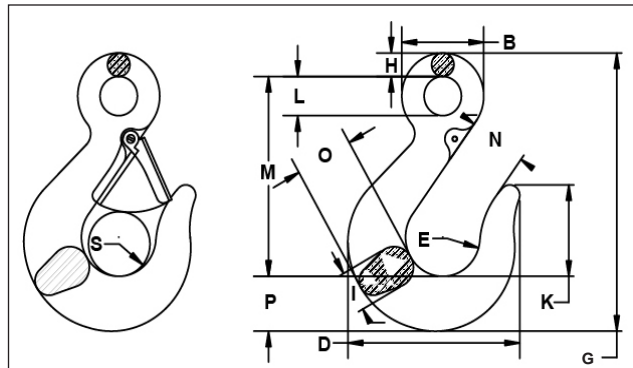

Grade	Chain Size (in.)	1Rated Cap.* (lbs.)	Part Number	Dimensions (in.)													Weight Each (lbs.)
				B	D	E	G	H	I	K	L	M	N	O	P	S	
100	7/32	2,700	732DESH	1.50	3.04	1.30	5.06	0.38	0.66	1.47	0.75	3.75	0.97	0.99	0.94	0.99	0.80
100	9/32	4,300	932DESH	1.65	3.48	1.50	5.25	0.45	0.75	1.75	0.72	3.75	1.19	1.21	1.05	1.10	1.10
100	3/8	8,800	38DESH	2.06	4.33	1.88	6.66	0.58	0.97	2.19	0.91	4.77	1.44	1.46	1.31	1.29	1.90
100	1/2	15,000	12DESH	2.63	5.50	2.25	8.16	0.77	1.10	2.56	1.09	5.67	1.78	1.91	1.68	1.63	4.50
100	5/8	22,600	58DESH	3.06	6.23	2.63	9.63	0.89	1.46	2.62	1.31	6.50	2.03	2.20	2.23	1.69	7.30
100	3/4	35,300	34DESH	3.50	7.82	3.00	11.38	1.00	1.69	3.47	1.50	7.81	2.50	2.82	2.58	2.31	11.40
80	7/8	34,200	78G8ESH	3.88	8.59	3.38	12.72	1.09	1.94	3.88	1.69	8.75	2.78	3.22	2.84	2.38	18.10
80	1	47,700	1G8ESH	4.31	9.59	4.00	14.23	1.22	2.14	4.25	1.88	9.88	3.13	3.55	3.09	2.88	22.60
80	1-1/4	72,300	114G8ESH	5.31	11.56	4.66	17.00	1.50	2.62	4.64	2.31	11.50	3.88	4.25	3.89	3.41	47.00

Note: Latches are not included on domestic hooks. If latches are required, you must specify latches when ordering.

* 1 Rated Capacity also referred to as Working Load Limit.

*** WARNING**

Do not exceed rated capacities. Sling capacity decreases as the angle from horizontal decreases. Do not use slings at angles of less than 30°. Refer to the Effect of Angle chart found in the General Information section of this catalog.

CHAIN SLING HARDWARE

Clevis Cradle Grab Hook – Code G

- For use with both G80 and G100 chain.
- Unique cradle grab design.
- 100% proof-tested.
- Quenched and tempered alloy steel.
- Fatigue rated.
- Durable powder-coated finish.
- Replacement pin available.
- Design factor 4:1.

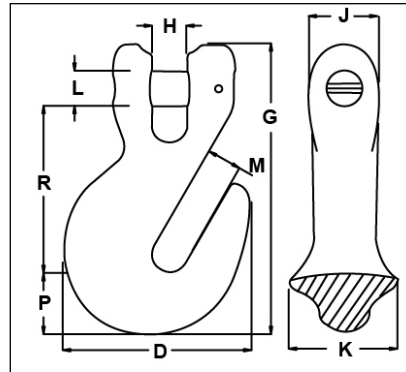

Chain Size (in.)	1Rated Capacity* (lbs.)	Part Number	Dimensions (in.)									Weight Each (lbs.)
			D	G	H	J	K	L	M	P	R	
9/32	4,300	932DCGH	2.18	3.39	0.38	0.82	0.97	0.36	0.38	0.82	1.86	0.63
3/8	8,800	38DCGH	2.72	4.33	0.47	1.18	1.29	0.51	0.74	1.03	2.47	1.30
1/2	15,000	12DCGH	3.65	5.27	0.65	1.39	2.01	0.63	0.60	1.19	3.04	2.10
5/8	22,000	58DCGH	4.50	6.54	0.77	1.55	2.42	0.75	0.77	1.41	3.76	4.20
3/4	35,300	34DCGH	5.40	8.80	0.88	2.05	2.69	0.88	0.91	1.89	5.30	10.50

Clevis Sling Hook – Code S

- For use with both G80 and G100 chain.
- Unique cradle grab design.
- 100% proof-tested.
- Quenched and tempered alloy steel.
- Fatigue rated.
- Durable powder-coated finish.
- Replacement pin available.
- Design factor 4:1.

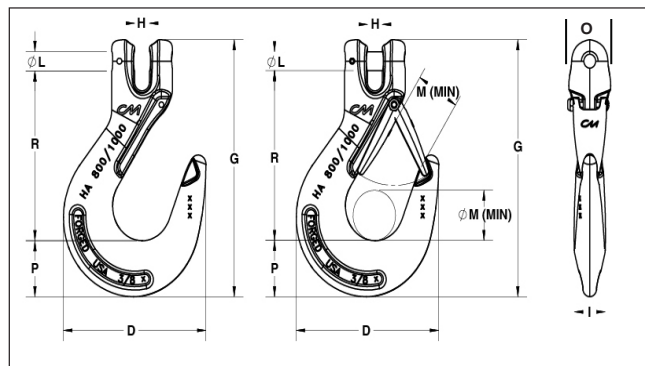

Shown with optional latch

Chain Size (in.)	1Rated Capacity* (lbs.)	Part Number	Dimensions (in.)									Weight Each (lbs.)
			D	G	H	I	L	M	O	P	R	
9/32	4,300	932DCSH	3.53	5.55	0.38	0.75	0.36	0.83	1.32	1.11	3.75	1.20
3/8	8,800	38DCSH	4.54	6.93	0.47	1.00	0.51	1.06	1.34	1.51	4.58	2.21
1/2	15,000	12DCSH	5.48	8.28	0.58	1.33	0.63	1.38	1.87	1.55	5.59	4.22
5/8	22,600	58DCSH	6.20	9.61	0.71	1.47	0.75	1.69	2.11	1.83	6.44	6.64
3/4	35,300	34DCSH	7.63	11.79	1.88	1.88	0.94	2.09	2.55	2.51	7.74	11.22

* Latches are not included. If latches are required, you must specify when ordering.

1 Rated Capacity also referred to as Working Load Limit.

*** WARNING**

Do not exceed rated capacities. Sling capacity decreases as the angle from horizontal decreases. Do not use slings at angles of less than 30°. Refer to the Effect of Angle chart found in the General Information section of this catalog.

CHAIN SLING HARDWARE

Oblong Master Link – Code O

- For use with both G80 and G100 chain, web bridle and *Tuflex* bridle slings.
- 100% proof-tested.
- May be used for mechanical and welded sling assemblies.
- Durable powder-coated finish.
- Design factor 4:1.

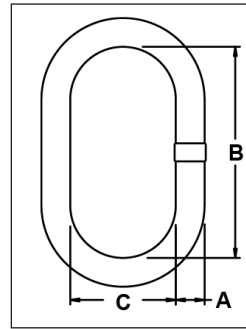

Master Link Size* (in.)			Part Number	Standard Oblong for Size and Configuration of Chain Sling				Weight Each (lbs.)
Diameter Material A	Inside Length B	Inside Width C		Single	Double	Triple	Quad	
13/32	3.00	1.50	1332DOL	7/32	7/32	–	–	0.3
1/2	5.00	2.50	12DOL	9/32	9/32	7/32	7/32	0.9
3/4	6.00	3.00	34DOL	3/8	3/8	9/32	9/32	2.5
1	8.00	4.00	1DOL	1/2 or 5/8	1/2	3/8	3/8	5.8
1-1/4	8.75	4.38	114DOL	3/4	5/8	1/2	1/2	9.2
1-1/2	10.50	5.25	112DOL	7/8	3/4	5/8	5/8	16
1-3/4	12.00	6.00	134DOL	1	7/8	3/4	3/4	25
2	14.00	7.00	2G8OL	1-1/4	1	7/8	7/8	37
2-1/4	16.00	8.00	214G8OL	–	1-1/4	1	1	54
2-3/4	16.00	9.00	234G8OL	–	–	1-1/4	1-1/4	85

Plate Hooks – G80

- Made with alloy steel.
- May be used for mechanical and welded sling assemblies.
- Design factor 4:1.
- Ratings are per hook.
- Do not use at angle other than 60° from horizontal.

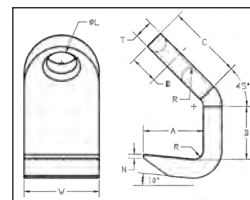

Chain Size (in.)	1Rated Capacity* (lbs.)	Part Number	Dimensions (in.)									Weight Each (lbs.)
			A	B	C	D	L	N	R	T	W	
9/32	4,200	932G8PH	2.00	1.75	2.50	0.93	1.00	0.12	0.31	0.63	2.50	2.80
3/8	7,400	38G8PH	2.63	3.00	4.31	1.18	1.12	0.18	0.38	0.75	2.75	5.70
1/2	13,000	12G8PH	3.50	4.00	4.38	1.50	1.50	0.25	0.50	1.00	3.50	13.0
5/8	20,400	58G8PH	4.38	5.00	4.43	1.87	1.88	0.31	0.63	1.25	5.00	26.5
3/4	30,000	34G8PH	5.19	6.00	6.50	2.38	2.25	0.38	0.75	1.50	5.75	42.0
7/8	40,000	78G8PH	6.00	7.00	7.63	2.50	2.63	0.473	1.00	1.75	6.00	65.0

* Rated Capacity also referred to as Working Load Limit.

Note: Never use plate hooks on a quad sling. Do not attempt to lift using only one plate hook.

* **WARNING** Do not exceed rated capacities. Sling capacity decreases as the angle from horizontal decreases. Do not use slings at angles of less than 30°. Refer to the Effect of Angle chart found in the General Information section of this catalog.

General Information
Web Slings
Round Slings
Sling Protection
Wire Rope
Chain Slings
Rigging Hardware
Mesh Slings
Load Huggers
Tow Products
Lift-All Hoists
Hoist Rings
Plate Clamps
Lifting Devices

CHAIN SLING HARDWARE Mechanical Coupling Links

- Used for overhead lifting slings to connect chain branches to the master link and to the hook attachments.
- Constructed of drop-forged alloy steel.
- Can be used with G80 and G100 chain.
- Must be matched to chain size.
- Do not use for chain repair or splicing.
- Meets ASTM A952 standards.
- Design factor 4:1.

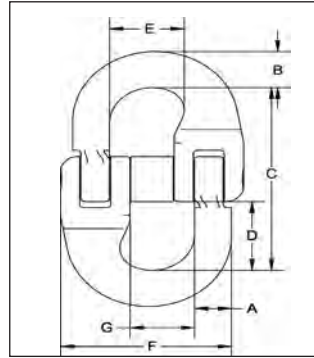

Grade	Chain Size (in.)	¹ Rated Capacity* (lbs.)	Part Number	Dimensions (in.)							Weight Each (lbs.)
				A	B	C	D	E	F	G	
100	7/32	2,700	732G10H	0.29	0.28	1.85	0.69	0.61	1.44	0.52	0.27
100	9/32	4,300	932G10H	0.37	0.44	1.94	0.69	0.68	1.58	0.61	0.28
100	3/8	8,800	38G10H	0.52	0.50	3.02	1.15	1.05	2.33	0.81	0.84
100	1/2	15,000	12G10H	0.64	0.68	3.79	1.43	1.29	2.98	1.10	1.87
100	5/8	22,600	58G10H	0.81	0.91	4.50	1.70	1.54	3.57	1.32	3.13
100	3/4	35,200	34G10H	0.97	1.07	5.36	2.06	1.78	4.69	1.52	5.75
80	7/8	34,200	78G8H	1.16	1.05	5.25	1.97	2.09	4.95	1.88	5.98
80	1	47,700	1G8H	1.32	1.25	6.00	2.31	2.37	5.87	2.33	9.47
80	1-1/4	72,300	114G8H	1.57	1.53	6.81	2.17	2.98	7.04	2.67	16.61

S-Hooks – G80

- Made from heat treated alloy steel.
- 100% proof-tested.
- Durable powder-coated finish.
- Working Load Limit is embossed on hooks.
- Design factor 4:1.

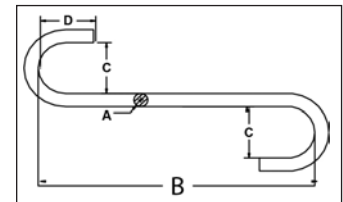

Stock Dia. (in.)	¹ Rated Capacity* (lbs.)	Part Number	Dimensions (in.)				Weight Each (lbs.)
			A	B	C	D	
9/32	210	932G8SH	0.28	4.50	1.13	1.13	0.15
3/8	410	38G8SH	0.38	6.00	1.50	1.50	0.35
1/2	870	12G8SH	0.56	7.50	2.00	2.00	1.04
5/8	1,120	58G8SH	0.63	9.00	2.50	2.50	1.56
3/4	1,730	34G8SH	0.75	10.50	3.00	3.00	2.60
7/8	2,370	78G8SH	0.88	12.00	3.50	3.50	4.20
1	2,920	1G8SH	1.00	13.00	4.00	4.00	6.00
1-5/32	3,150	1532G8SH	1.13	15.00	4.50	4.50	9.30
1-1/4	4,450	114G8SH	1.25	16.00	5.00	5.00	11.70
1-3/8	6,100	138G8SH	1.38	17.00	5.50	5.50	15.40
1-1/2	6,250	112G8SH	1.50	18.00	6.00	6.00	19.50



¹ Rated Capacity also referred to as Working Load Limit.

*** WARNING**

Do not exceed rated capacities. Sling capacity decreases as the angle from horizontal decreases. Do not use slings at angles of less than 30°. Refer to the Effect of Angle chart found in the General Information section of this catalog.

FOUNDRY SORTING HOOKS & J-HOOKS

Welded alloy steel hooks are heat-treated with a shot blast finish, proof-tested and certified.

Foundry Sorting Hooks

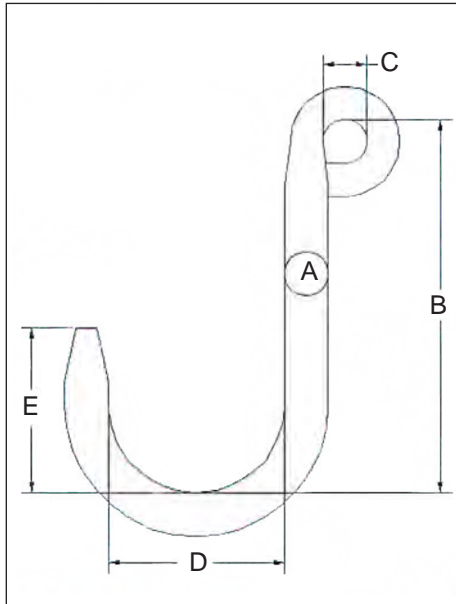

Standard Foundry Sorting Hooks - G80

Part Number	A	B	C	D	E	Chain Size Eye Fits Mechanical Coupler	¹ Rated Capacity* (lbs.)
FSA050	0.50	6.00	0.75	2.50	2.00	0.28	500
FSA063	0.63	8.50	0.75	3.50	3.25	0.28	800
FSA075	0.75	8.50	0.75	3.50	3.25	0.28	1300
FSA081	0.81	8.50	0.88	3.50	3.25	0.38	1600
FSA100	1.00	8.50	1.00	4.00	3.75	0.38	2500
FSA113	1.13	8.50	1.00	4.00	4.00	0.38	3500
FSA125	1.25	8.50	1.25	4.00	4.00	0.50	4500
FSA150	1.50	8.50	1.25	5.00	4.00	0.50	6000

Short Foundry Sorting Hooks - G80

Part Number	A	B	C	D	E	Chain Size Eye Fits Mechanical Coupler	¹ Rated Capacity* (lbs.)
FSA050S	0.50	6.00	0.75	3.00	3.00	0.28	450
FSA063S	0.63	6.00	0.75	3.00	3.00	0.28	900
FSA075S	0.75	6.00	0.75	3.00	3.00	0.28	1400
FSA088S	0.88	6.00	0.88	3.00	3.00	0.38	2000
FSA100S	1.00	6.00	1.00	3.00	3.00	0.38	3000
FSA113S	1.13	6.00	1.00	3.00	3.00	0.38	4000
FSA125S	1.25	6.00	1.25	3.00	3.00	0.50	5500

Standard J-Hooks

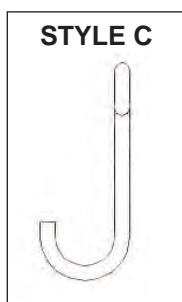
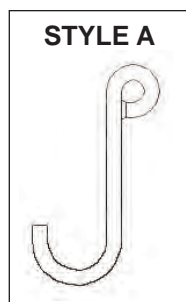
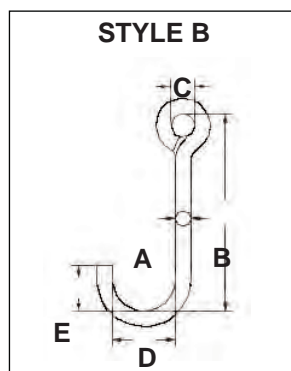

Flat Tip J-Hooks - G80

Part Number	Part Number	Part Number	A	B	C	D	E	¹ Rated Capacity* (lbs.)
JAA038	JBA038	JCA038	0.38	6.00	0.75	1.50	1.13	350
JAA050	JBA050	JCA050	0.50	8.00	0.75	2.00	1.50	650
JAA063	JBA063	JCA063	0.63	9.00	1.00	2.50	1.88	850
JAA075	JBA075	JCA075	0.75	10.00	1.00	3.00	2.25	1200
JAA088	JBA088	JCA088	0.88	12.00	1.00	3.50	2.63	1500
JAA100	JBA100	JCA100	1.00	14.00	1.25	4.00	3.00	2000
JAA113	JBA113	JCA113	1.13	15.00	1.25	4.50	3.37	2250
JAA125	JBA125	JCA125	1.25	16.00	1.50	5.00	3.75	2750

* Rated Capacity based on bearing to bearing pull. Tip load capacity averages 30% of bearing to bearing rating.

¹ Rated Capacity also referred to as Working Load Limit.

Note: Other sizes available upon request.