

## WEB SLING HARDWARE

### WEB-TRAP™ STEEL SLING HARDWARE - TRIANGLES & CHOKERS

A significant improvement in triangle/choker design, *Web-Trap* fittings feature positive web capture to eliminate web slippage. These fittings are manufactured from alloy steel for lighter sling weight and a powder-coated finish to inhibit rust.



Webbing can slip with ordinary fittings.

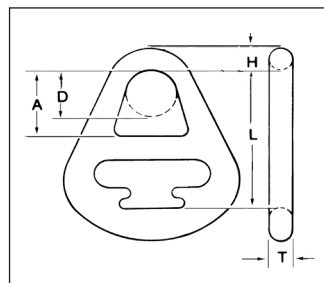
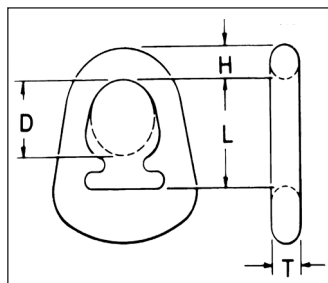

*Web-Trap* locks webbing to center of hardware.

#### ALLOY STEEL FOR 1-PLY & 2-PLY SLINGS

Web-Trap Triangles						Web-Trap Chokers						
Web Width	Dimensions (in.)				Weight (lbs.)	Web Width	Dimensions (in.)					Weight (lbs.)
	L	D	T	H			L	A	D	T	H	
*2"	2.38	1.75	.56	0.63	1.0	*2"	5.00	2.44	1.75	.56	0.69	1.9
*3"	3.44	2.00	.50	0.75	1.9	*3"	6.25	3.38	2.00	.50	0.75	3.6
*4"	4.13	2.38	.50	0.81	2.8	*4"	7.00	4.00	2.38	.50	0.81	5.1
6"	5.56	3.13	.50	1.06	6.3	6"	8.88	4.75	3.13	.50	1.06	12

\* *Unilink* is standard fitting - triangle and chokers available on special order only.

#### ALLOY STEEL FOR 1-PLY SLINGS

Web-Trap Triangles						Web-Trap Chokers						
Web Width	Dimensions (in.)				Weight (lbs.)	Web Width	Dimensions (in.)					Weight (lbs.)
	L	D	T	H			L	A	D	T	H	
8"	6.50	4.0	.50	1.25	8	8"	11.25	7.50	4.00	.50	1.44	16
10"	8.25	5.0	.75	1.44	16	10"	12.88	8.25	5.00	.75	1.50	28
12"	8.75	5.5	.75	1.75	20	12"	14.50	10.0	5.50	.75	1.75	40

#### ALLOY STEEL FOR 2-PLY SLINGS

Web-Trap Triangles						Web-Trap Chokers						
Web Width	Dimensions (in.)				Weight (lbs.)	Web Width	Dimensions (in.)					Weight (lbs.)
	L	D	T	H			L	A	D	T	H	
8"	6.50	4.0	.75	1.25	12	8"	11.25	7.50	4.0	.75	1.438	25
10"	8.25	5.0	1.0	1.438	21	10"	12.88	8.25	5.0	1.0	1.50	38
12"	8.75	5.5	1.0	1.75	27	12"	14.50	10.0	5.50	1.0	1.75	54

## TUFF-EDGE® & WEBMASTER® 1600 POLYESTER SLINGS

### TYPE U - UNILINK™ HARDWARE SLINGS



Ply	Tuff-Edge III Part No.*	Web Width (in.)	Rated Capacity* (lbs.)			Webmaster 1600 Polyester Part No.***	Webmaster 1600 Nylon Part No.***
			Vertical	Choker	V. Basket		
One Ply	UU1802T	2	3,200	2,500	6,400	UU1802D	UU1802N
	UU1803T	3	4,800	3,800	9,600	UU1803D	UU1803N
	UU1804T	4	6,400	5,000	12,800	UU1804D	UU1804N
Two Ply	UU2802T	2	6,400	5,000	12,800	UU2802D	UU2802N
	UU2803T	3	8,800	7,040	17,600	UU2803D	UU2803N
	UU2804T	4	11,500	9,200	23,000	UU2804D	UU2804N

\*Replace the UU with TT or TC in part number above if Type 1 or Type 2 is required.

### TYPE 1 (TC) & TYPE 2 (TT) WEB-TRAP™ HARDWARE SLINGS

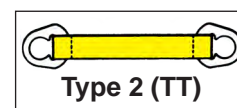
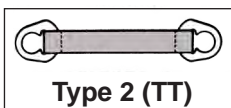
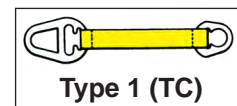
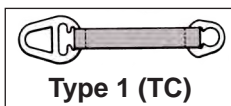

Ply	Tuff-Edge III Part No.		Web Width (in.)	Rated Capacity* (lbs.)			Webmaster 1600 Polyester Part No.***		Webmaster 1600 Nylon Part No.***	
	Type 1	Type 2**		Vertical	Choker	V. Basket	Type 1	Type 2**	Type 1	Type 2**
One Ply	TC1806T	TT1806T	6	9,600	7,700	19,200	TC1806D	TT1806D	TC1806N	TT1806N
	TC1808T	TT1808T	8	12,800	10,200	25,600	TC1808D	TT1808D	TC1808N	TT1808N
	TC1810T	TT1810T	10	16,000	12,800	32,000	TC1810D	TT1810D	TC1810N	TT1810N
	TC1812T	TT1812T	12	19,200	15,400	38,400	TC1812D	TT1812D	TC1812N	TT1812N
	TC1816T	TT1816T	16	25,500	20,400	51,000	TC1816D	TT1816D	TC1816N	TT1816N
Two Ply	TC2806T	TT2806T	6	16,800	13,400	33,600	TC2806D	TT2806D	TC2806N	TT2806N
	TC2808T	TT2808T	8	22,400	17,900	44,800	TC2808D	TT2808D	TC2808N	TT2808N
	TC2810T	TT2810T	10	28,000	22,400	56,000	TC2810D	TT2810D	TC2810N	TT2810N
	TC2812T	TT2812T	12	33,600	26,800	67,200	TC2812D	TT2812D	TC2812N	TT2812N
	TC2816T	TT2816T	16	44,800	35,800	89,600	TC2816D	TT2816D	TC2816N	TT2816N

\*\* Type 2 (TT) cannot be used in a choker hitch.

\*\*\* To order aluminum hardware, single ply 2" - 6" only, add A after TC or TT.

Custom configurations available.

\*



**WARNING**

Do not exceed rated capacities. Sling tension increases as the angle from horizontal decreases. Slings should not be used at angles of less than 30°. Refer to the Effect of Angle chart in the General Information section of this catalog. **Always protect synthetic slings from being cut by corners and edges. See the Sling Protection section in this catalog.**

General Information  
Web Slings  
Round Slings  
Sling Protection  
Wire Rope  
Chain Slings  
Rigging Hardware  
Mesh Slings  
Load Huggers  
Tower Products  
Lift-All Hoists  
Hoist Rings  
Plate Clamps  
Lifting Devices